

**Series 6500  
Counter Shutters**

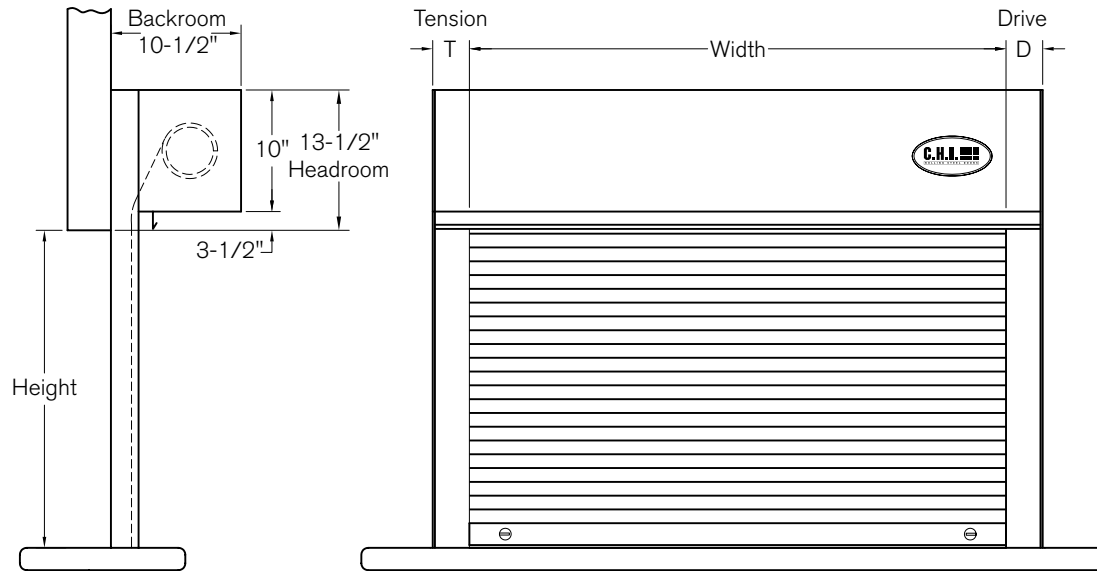

**Face of Wall Mount**  
Aluminum & Steel

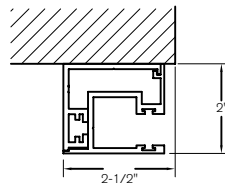

	D	T
Manual	2-1/2"	2-1/2"
Awning Crank	4-1/2"	2-1/2"
Motor	2-1/2"	2-1/2"

**Between Jamb Mount**  
Aluminum & Steel

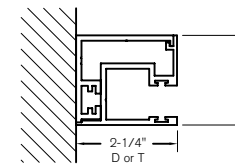

	D	T
Manual	2-1/4"	2-1/4"
Awning Crank	4-1/4"	2-1/4"
Motor	4-1/4"	2-1/4"

**Face of Wall Mount**  
Stainless Steel

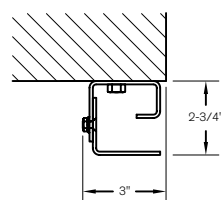

	D	T
Manual	3-1/2"	4-1/2"
Awning Crank	5"	4-1/2"
Motor	5"	4-1/2"

**Between Jamb Mount**  
Stainless Steel

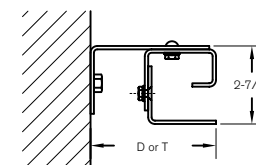

	D	T
Manual	3-1/2"	4-1/2"
Awning Crank	5"	4-1/2"
Motor	5"	4-1/2"